

## Silent Block for Anchor Link

Technology: Compression Moulding

|  |  |
|--|--|
| Basic Polymer used   | Natural Rubber                         |
| Operation Temperature  | -10°C to 70°C                          |
| Operational Atmosphere   | Heavy Dusty /Corrosive /Salty          |
| Operational Humidity   | 0 to 100%                              |
| Metal Parts Spec   | Steel IS: 1875 Cl.4, IS: 2062 Fe 410 A |
| <b>Properties of Elastomer (Conventional Silent Block for Anchor Link)</b> |  |
| Shore A Hardness   | 75 to 85                               |
| Tensile Strength   | 180 Kg/cm <sup>2</sup> Minimum.        |
| Elongation at Break  | 280% Minimum.                          |
| Modulus at 200%  | 125 Kg/cm <sup>2</sup> Minimum.        |
| Compression Set  | 25% Maximum                            |
| Ash Content  | 5% Maximum                             |
| Specific Gravity   | 1.20 Nominal                           |
| Bond Strength  | 500 PSI                                |

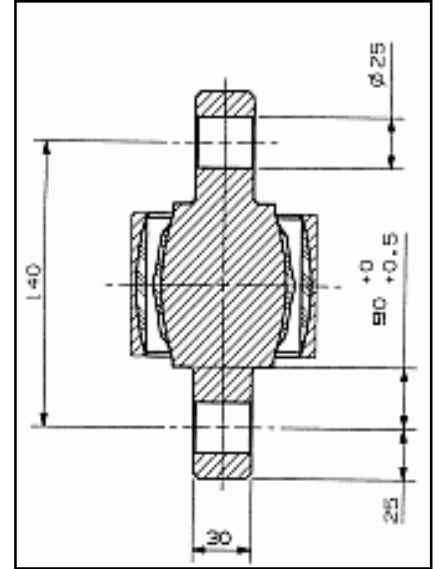

### Properties of Conventional Silent Block for Anchor Link

|   |   |
|---|---|
| Conical Stiffness for 8° Deflection           | Torque: 8000-10000 Kg. cm<br>Permanent Set: 0.5° Max. |
| Torsional Stiffness at 8° Deflection          | Torque: 8000-10000 Kg. cm<br>Permanent Set: 0.5° Max. |
| Compressive Load - Deflection Characteristics | Deflection : 2 mm<br>Load 8000 Kg. Max.               |

### Properties of Silent Block for Anchor Link (FIAT)

| Operational Condition | Maximum Capacity |
|-----------------------|------------------|
| Radial Load           | 7300 Kg          |
| Torsional Angle       | 10°              |
| Conic Angle           | 10°              |

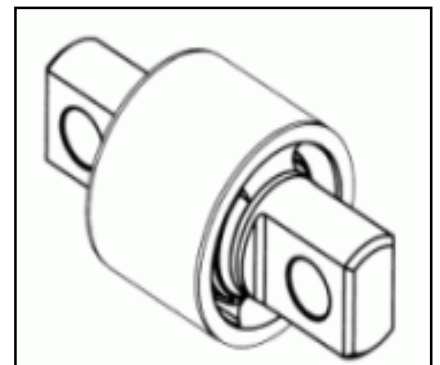

**Silent Block for Anchor Link**

**Note:** Design, Dimension & Properties can be changed to suit customer's requirement. Diameter can be upto 300 mm